

<b>INTERVALVE®</b> (ENGINEERING DATA SHEET)		DOC NO. : IVED-003
Title : <b>Product Specification for IVGE / IVTLE model Butterfly Valve</b>		REV NO. : 0
		DATE : 02/11/01
		PAGE NO. : 1 OF 1
<b>GENERAL FEATURES</b>	VALVE TYPE	CENTRIC DISC BUTTERFLY
	VALVE MODEL	IVGE / IVTLE
	DESCRIPTION	BUTTERFLY VALVE WITH A RUBBER LINED BODY AND RUBBER ENCAPSULATED DISC
	DESIGN, MFG. STD.	API 609 / EN593
	FACE TO FACE DIMENSION	API 609 / ISO 5752 TAB 5
	TESTING STANDARD	API 598 / BS 6755 PT I
	TOP FLANGE	ISO 5211.2
<b>PRODUCT SPECS.</b>	SIZE RANGE	50 NB TO 350 NB
	OPERATING TEMPERATURE	- 25° C ~ +140° C. (DEPENDING ON MOC)
	PRESSURE CLASS RATING	PN 10
	BODY TYPE	WAFER (IVGK)                      WAFER LUGGED (IVTL)
	FLANGE STANDARDS	ANSI 150; DIN PN 6/10/16; NP 0.6/1.0/1.6; JIS 5K/ 10K/16K; BS 10 TAB D & E                      ANSI 150, DIN PN 10/16 ; NP/1.0/1.6; BS 10 TAB D & E
	DISC TYPE	FULLY RUBBER ENCAPSUALTED WITH A SQUARE DRIVE FOR SHAFT ENGAGEMENT
	SEAT TYPE	INTEGRALLY MOULDED WITH BODY HAVING SPHERICAL PROFILE
	SEAT LEAKAGE	ZERO LEAK, TIGHT SHUT OFF
	FLOW DIRECTION	BIDIRECTIONAL
	PAINTING & FINISH	EPOXY POWDER COATED (EXCEPT ST. STEEL)
<b>MATL. OF CONSTRUCTION</b>	BODY MATL.	SGI / WCB / CF8 / CF8M / OTHERS ON REQUEST
	DISC MATL.	SGI + RUBBER ENCAPSULATION
	SEAT & ENCAPSULATION	NITRILE, EPDM, HYPALON, OTHERS ON REQUEST
	SHAFT MATL.	AISI 410 / 316 OTHERS ON REQUEST
	BEARING FOR SHAFT	ST.STEEL BACKED PTFE (SELF LUBRICATED)
	SHAFT SEALING	O-RINGS
<b>OPERATION</b>	STD. PRESSED HAND LEVER	FOR SIZES 50 NB TO 150 NB ONLY
	CAST HAND LEVER	FOR SIZE 200 NB
	GEAR BOX	250 NB TO 350 NB (OPTIONAL ON SMALLER SIZES)
	ACTUATOR (ELECT. / PNEUMATIC)	OPTIONALLY AVAILABLE ON FULL RANGE.
1. SPECIFICATION SUBJECT TO CHANGE WITHOUT NOTICE DUE TO CONTINUOUS IMPROVEMENT.		
2. OTHER MATERIAL OPTIONS OR NON-STANDARD REQUIREMENTS AVAILABLE ON REQUEST.		
<b>PREPARED BY</b>		<b>APPROVED BY</b>

VALVE DIMENSIONS												
VALVE SIZE	A	B	C	D	E	F	G	H	J	ØK	M	L
50	50	43	73	113	9	70	4	20	2.5	12	1.5	32
65	65	46	80	121	9	70	4	20	2.5	12	1.5	32
80	80	46	88	128	9	70	4	20	2.5	12	1.5	32
100	100	52	104	146	9	70	5	20	3	16	2	32
125	125	56	116	158	9	70	5	20	3	16	2	32
150	150	56	138	174	11	102	6	20	3.5	20	2.5	32
200	200	60	163	198	11	102	6	20	3.5	20	2.5	32
250	250	68	203	245	11	102	8	25	4	30	3	32
300	300	78	228	270	14	125	8	25	4	30	3	32
350	336	78	265	312	14	125	8	25	4	30	3	32

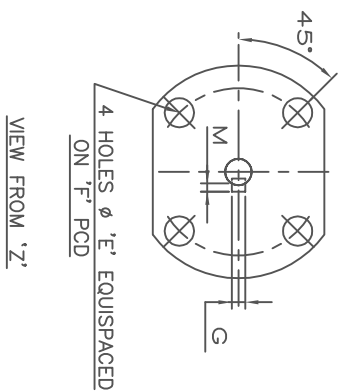
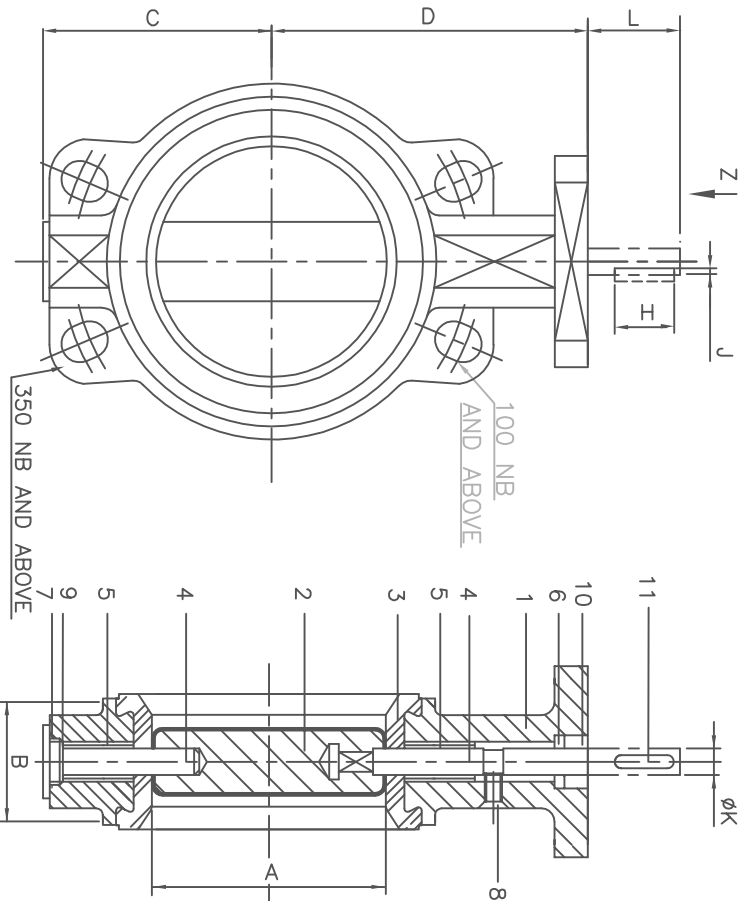

FLANGE STD:PN10/16/ANSI c11501b  
 VALVE RATING - PN10  
 MFG STD - API 609  
 TEST STD - API 598  
 HYD TEST PRESS - 1) BODY 15 KG/CM2  
 2) SEAT 11 KG/CM2

CAUTION:- DO NOT USE FLANGE GASKETS DURING VALVE INSTALLATION.

@@ - FOR MATERIALS PLEASE ENQUIRE

11	KEY	1	EN8
10	TOP BUSHING	1	POLYACETAL
9	PLUG	1	C-15
8	CSK SCREW	1	ASI 304
7	O RING PLUG	1	@@@
6	O RING SHAFT	1	@@@
5	BEARING	2	ST.STEEL+PTFE
4	SHAFT	2	@@@
3	BONDED SEAT	1	@@@
2	DISC	1	@@@
1	BODY	1	@@@
NO	DESCRIPTION	QTY	MATL.
TQ NO:-			APPD
IV NO:-			DT.
VGE BUTTERFLY VALVE WITH BARE SHAFT			CHKD
			DT.
DRG.NO.	Pd14517/MDS066	DRN.	BMW
		DT.	30.8.05

INTERVALVE

REV. MOD.NO. DATE SIGN IF IN DOUBT. ASK. SCALE N.T.S.