

GATE VALVES—Class 2500#

Size range: 2" to 20"

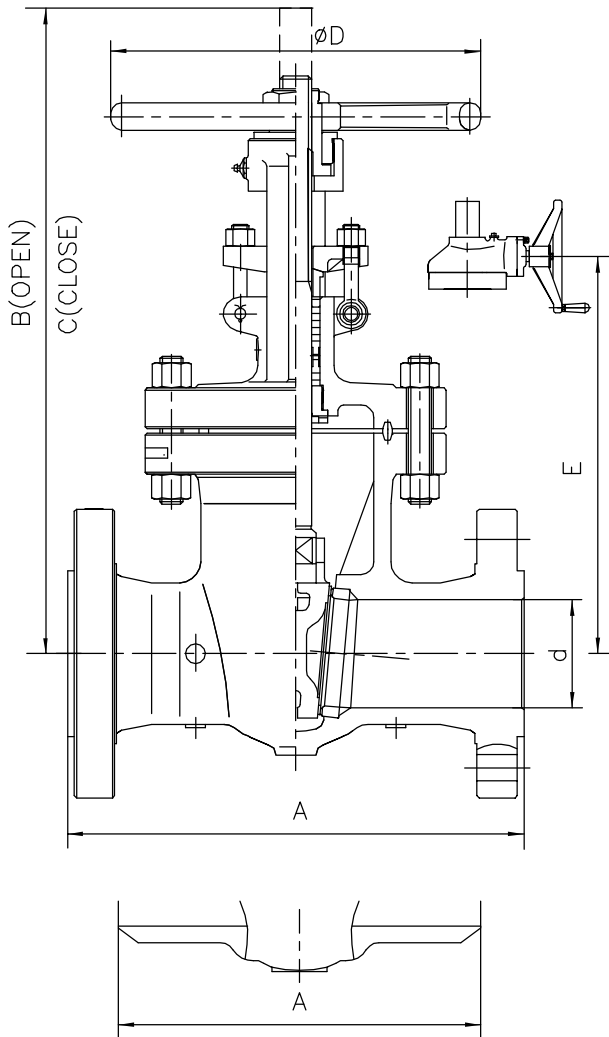

STANDARDS:

Design	ANSI B16.34&API 600
Test	API 598
Face to Face Dimensions	ANSI B16.10
End Flange Dimensions	ANSI B16.5
Butt-Weld Ends	ANSI B16.25

Class 2500# Fig NO. 77(RF/RTJ)
77 1/2 (BW)

DIMENSIONS AND WEIGHTS

Size inch	d	A RF & BW	B (OPEN)	C (CLOSE)	D	E	Weight(kg) RF & BW	
2"	38	451	540	480	310		147	125
3"	57	578	691	610	380	710	293	236
4"	73	673	855	760	510	860	425	370
6"	111	914	1152	1003	700	1103	1328	1040
8"	146	1022	1532	1340	1100	1483	1836	1700
10"	184	1270	1720	1500	1100	1693	3289	3100
12"	219	1422	2292	2042	1100	1753	4189	3780

Other Sizes and materials: On request

RF: Flanged BW: Butt Weld

Sizes 3" and larger the use of gear actuator is recommended.

AVAILABLE OPTIONS:

STRUCTURE	End Connection: Flange Raised Face, Butt Weld, RTJ...
	Seat Rings: Threaded (Renewable), Welded
	Operation: Handwheel, Gear, Electric, Pneumatic, Hydraulic...
* MATERIALS	Body: WCB, WC1, WC6, WC9, LCB, LCC, LC3, C5, C12, CF8, CF8M, CF3, CF3M, CF8C...
	Trims: 13%Cr, 304, 304L, 316, 316L, 321, 347, F-51, Monel...
ACCESSORIES	Limited switch, Sealing water connection, Bypass, Drain, Equalizing pipes and Etc.

* Please refer to page of "Build Material"